



Comox News

October 2015

The Town of Comox Community Newsletter

Marina Park Vitalization Plan update

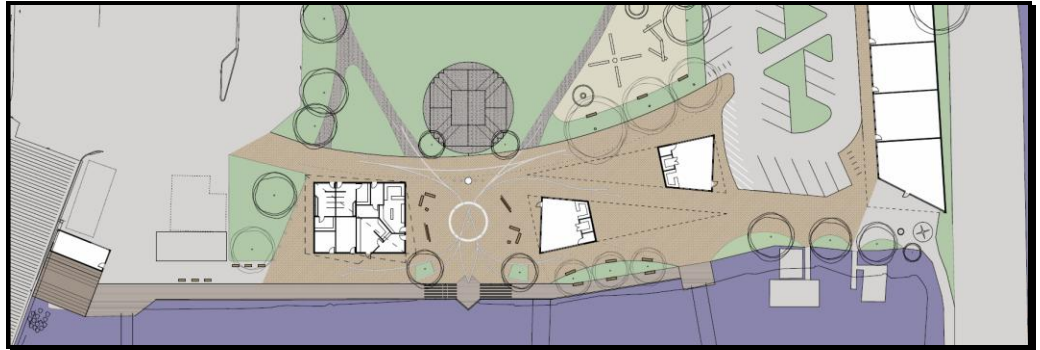

Inside:

- *Water conservation*
- *Nuisance mosquitoes*
- *Subdivision and development servicing update*
- *Bike lanes*
- *Lateral X Elliptical*
- *Filberg Heritage Lodge and Park – rock wall*
- *Emergency Preparedness training*
- *Stormwater drainage*
- *Road resurfacing*

Work on the Marina Park Vitalization Project continues, with a summary of public feedback received from two open houses being presented to Council in October. Upon receiving approval from Council to

proceed with the next steps, detailed design will be completed by December 2015 and the project will be put out to tender early in 2016. Tentative construction dates are set for the

spring/summer of 2016. Construction will result in some disruption in Marina Park for the coming year; however, all events scheduled to be held in the park will proceed with minimal disruption.

New fire department truck



The Comox fire department recently put into service a new pick-up truck for daily Duty Officer functions. For many years now, the fire department has operated

with two pick-up trucks – one as a Duty Officer vehicle and the other as a back-up and unity function. The new pick-up truck will

be the fire department's most used vehicle over the next few years and replaces a 1998 model. Both it and the backup vehicle are set up to tow all of the fire department's three trailers (fireboat, hazmat and sprinkler trailers).

The new truck will be dedicated to deceased Comox Fire Captain Stewart Rennie who passed away peacefully a couple of years ago while still an active member of the fire department.

The 1998 truck has been given to the Ship's Point fire department for a nominal fee.

Water conservation

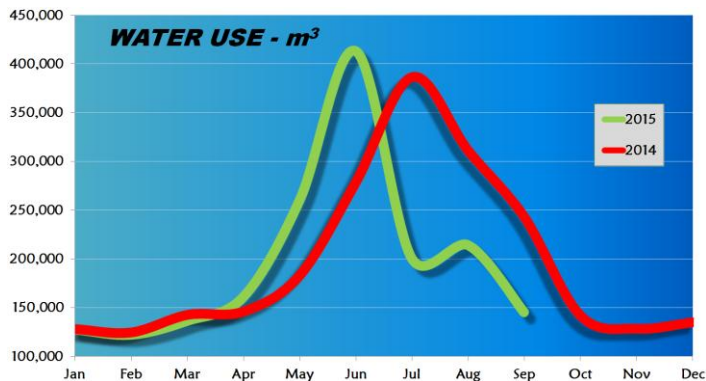

This summer was particularly hot and dry, leading to the implementation of Stage 3 watering restrictions on July 3, 2015. Public compliance with these watering restrictions, together with Town initiatives to find and fix leaks, significantly reduced our water use over the summer. 2014 water use in the above graph shows the Town's typical use, with over 900,000 cubic meters during the July-September period. This year, the Town only used 560,000 cubic meters of water during this period (a reduction of over 60%), which is a tremendous improvement.

Reducing water use has many advantages. This year was particularly important, as the water in Comox Lake was reaching a dangerous level below which the Puntledge River may have dried up (while not only important for fish habitat, the Puntledge is where we get our drinking water).

Another advantage is that, because we buy our water from the Regional District, reducing water use saves Comox taxpayers money. Typically water costs over \$1.5 million per year. Because of reduced use this year, water costs could drop by up to \$100,000.

As weather becomes more extreme, we are likely to see more periods of extended drought in the future, meaning we need conserve what water is in the Lake for essential uses. For now we have returned to Stage 1 water use regulations, but we encourage all our customers to be aware of their water use and make an effort to conserve this precious resource.

Subdivision and development servicing update

The Town is undertaking a comprehensive review and update of its Subdivision and Development Servicing Bylaw. At the time of subdivision or building permit, developers are required to build certain public services,

such as roads and underground utilities (water plus sanitary and storm sewers). This bylaw specifies the type and to what standard these services must be constructed.

The purpose of the update is to provide greater clarity and

Nuisance mosquitoes

After receiving multiple complaints from Kye Bay area residents of aggressive mosquitoes, the Town and the Comox Valley Regional District jointly commissioned Current Environmental of Courtenay to do some investigating.

Current Environmental conducted larva counts in a number of potential mosquito producing sites, such as roadside ditches, the Kye Bay slough and some private property locations. What they found was extremely high (and climbing) counts of *aedes dorsalis* larva in the Kye Bay slough.

The *aedes dorsalis*, or Salt Marsh Mosquito, is very aggressive and noticeable near marshes. The species is capable of producing very high numbers and larvae live in brackish waters. Based on this, control measures

were taken to avoid another summer with a potentially large population of aggressive mosquitoes.

Sand and cobble from the seaward side of the slough was used to partially fill it in and the area was fully drained. Work conducted would not only control the overpopulation of this particularly aggressive mosquito, but would also partially restore habitat for the provincially red-listed dune wildrye and beach pea ecosystem.

In the end, the mosquito abatement program has been a total success, with the residents in the Kye Bay, Knight Road and Point Holmes areas extremely happy and appreciative of the efforts made by both the Town of Comox and Regional District.

For more details, see our Facebook site.



certainty for the development community and staff. The changes will consolidate and streamline the existing bylaw and help in administering the development review process. The updated

bylaw will make it easier for residents and developers to understand the Town's development policies and will support the Town's commitment to building more sustainable infrastructure.

Bike lanes

Bike lanes are lanes separated from the road by a single solid white line, and designated by a diamond and bicycle symbol. Currently bike lanes exist along Guthrie Road, Anderton Road, Noel Avenue, Comox Avenue west of Anderton and Pritchard Road north of Guthrie.

As the Town builds more bike lanes adjacent to major roads, we would like to remind motorists that bike lanes are **NOT** part of the roadway and are intended for use by cyclists only.

Please remember that motorists cannot drive, park or stop in these lanes.

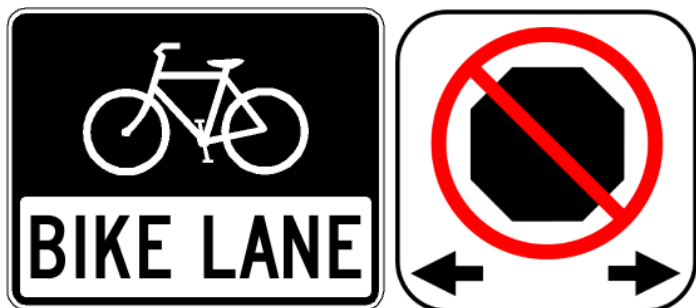

Filberg Heritage Lodge and Park – rock wall

The rock wall along the lower section of Filberg Park was built with beach rock over 80 years ago. As such, it has significant heritage value. While it has done a fabulous job of holding the bank back all these years, one section closer to the lodge was showing signs of failing.

In an effort to preserve the look and heritage value of the wall, the failing section has been rebuilt using the original stones. After cleaning the original mortar off, over 90% of the stones used in the rebuilt wall were original.

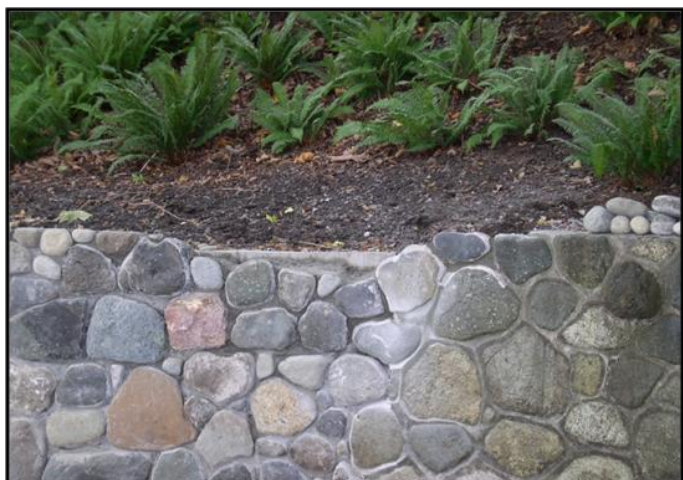

Lateral X Elliptical



Add excitement and a new dimension to your cardio workout this fall with the Community Centre’s new Lateral X Elliptical machine. The Lateral X will move you in an entirely new direction, with smooth 3-D motion that goes from a vertical elliptical stepping motion to an active side to side that challenges the entire body for better conditioning and even better results. Research shows that the Lateral X user benefits from a 27% increase in calorie burn and a 30% increase in

inner and outer thigh workout over a traditional elliptical. Users also appreciate the variety in movement and the ability to target the glutes, hips and thighs. Hockey players, figure skaters, tennis and pickleball players, snowboarders and skiers, are among the many sports enthusiasts who find that the Lateral X is the one machine that truly targets lateral movement ... after all, your sport isn’t linear so why should your cardio machine be.

Emergency Preparedness Training

Comox Fire Rescue is offering additional FREE Emergency Preparedness training. Experience has shown that after a disaster, emergency services may take **three or more** days to reach households. This training is designed to provide information and skills

necessary for individuals and neighbourhoods to be self-sufficient after a disaster.

The next scheduled program is on November 20 at the Comox Fire Station, between 10:00 a.m. and 12:00 p.m. Phone 250 339-2255 to register.

Town of Comox

1809 Beaufort Avenue
Comox, BC V9M 1R9

PHONE:
(250) 339-2202

FAX:
(250) 339-7110

E-MAIL:
town@comox.ca

Staff Contacts

Richard Kanigan
Chief Administrative Officer

Shelley Ashfield
Municipal Engineer

Al Fraser
Parks Superintendent

Don Jacquest
Treasurer

Mandy Johns
Recreation Director

Marvin Kamenz
Municipal Planner

Shelly Russwurm
Deputy Corporate Administrator

Gord Schreiner
Fire Chief

Council

Paul Ives
Mayor

Russ Arnett
Councillor

Ken Grant
Councillor

Marg Grant
Councillor

Hugh MacKinnon
Councillor

Barbara Price
Councillor

Maureen Swift
Councillor

We're on the Web!

See us at:
comox.ca or

www.facebook.com/townofcomox

Storm water drainage



Beneath most streets in the Town is a storm water collection system, which is a series of pipes that collect rainwater and carry it to the ocean. The system is especially important during storms, when the high volume of rainwater falling onto streets would otherwise cause flooding.

Rainwater from the streets enters the storm water collection system through grated storm drains, also called catch basins, which can be found along the edges of the streets. There are 1,983 catch basins in the Town of Comox.

In order for the storm water collection system to work efficiently, catch basins must not be clogged with recently fallen leaves, needles and twigs.

Once clogged, rainwater cannot drain from the streets, and leads to flooded streets and homes.

With the arrival of this year's storm season, the Town of Comox is once again requesting the assistance of the public in clearing leaves and debris from catch basins. Know where the catch basins are along your street, and inspect in the fall before rain storms. If you do notice that one is clogged, use a rake to clear the debris and place in your organics collection bin.

If you see a catch basin filled with debris below the grate, or if you cannot clear the basin near your property yourself, contact Town hall and advise of the particular location. Never attempt to remove a storm drain grate, only the debris on top of the grate. Please also remember to never deposit or blow leaves onto the street as our limited staff and equipment resources do not allow for prompt removal.

Thank you for your cooperation!

Road re-surfacing

This year, the Town once again undertook significant road rehabilitation and improvement projects. A total of 946 m (0.9 km) of roads were resurfaced this year, with costs coming in significantly under budget. Resurfacing projects included

- Wallace Avenue (east of Gladstone),
- Torrence Road (north of Guthrie),
- Balsam Avenue,
- Fairway Court,
- Georgia Court,
- Short Street,
- Sonora Place,
- Stewart Street (Balmoral to Balsam),
- Texada Place, and
- Victoria Court.

Notices

School Zones

Please remember that school zones can be unsafe if the following parking and driving practices are not adhered to:

No parking

- on sidewalks or boulevards
- in front of or within 5 metres of fire hydrants
- across or within 6 metres of crosswalks
- across or within 6 metres of intersections and public entranceways
- in loading zones or bus zones, except as permitted by sign

- across or within 2 metres of private driveways
- within 6 metres of stop signs

Maximum speed limit of 30 kilometres

No U-turns where prohibited by sign

This newsletter is a result of Council's initiative to increase communication with residents. If you have any comments or suggestions, or would like to see anything in particular in upcoming editions, please contact us.